

# MISC. PIPE FITTINGS

**DEAN BENNETT SUPPLY CO**  
 1770 E. 69th AVE. DENVER, CO 80229  
 PH 303-286-1500 FAX 303-286-0001  
 TOLL FREE 800-621-4291

10 - 15 - 08 NET PRICES



**BRASS INSERT COUPLINGS - - - Barb x Barb**  
 3/4" 7IBCUP \$ 5.10 1" 10IBCUP \$ 8.05 1-1/4" 12IBCUP \$ 12.15



**EXTRA LONG INSERT COUPLINGS - - - 12 Barbs for Extra Holding Power**  
 1" 10IXLBCUP \$ 11.00 1-1/4" 12IXLBCUP \$ 17.75 2" 20IXLBCUP \$ 31.50



**BRASS ROPE EYED MALE ADAPTERS - - Barb x Male Thread with Rope Eye**  
 1" Barb x 1" Male Pipe Thread with Eye for Safety Rope \$ 9.40 BRA4  
 1" Barb x 1-1/4" Male Pipe Thread with Eye for Safety Rope \$ 10.95 BRA54  
 1-1/4" Barb x 1-1/4" Male Pipe Thread with Eye for Safety Rope \$ 11.95 BRA5

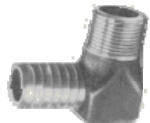

**INSERT BRASS MALE ADAPTERS - - Barb x Male Pipe Thread**  
 3/4" 7IBMA \$ 4.80 1" 10IBMA \$ 8.10 1-1/4" 12IBMA \$ 10.35 2" 20IBMA \$ 19.95

**INSERT BRASS FEMALE ADAPTERS - - Barb x Female Pipe Thread**  
 1" 10IBFA \$ 9.30 1-1/4" 12IBFA \$ 11.35

**EXTRA LONG BRASS INSERT MALE ADAPTERS - 12 Barbs for Extra Hold**  
 1" 10IXLBMA \$ 10.35 1-1/4" 12IXLBMA \$ 14.40 2" 20IXLBMA \$ 25.05



**SPECIAL BRASS INSERT HYDRANT FITTINGS - - Barb x Male Thread**  
 3/4" Barb x 3/4" Male Pipe Thread...Brass Hydrant Elbow 7IBHL \$ 7.85  
 1" Barb x 3/4" Male Pipe Thread...Brass Hydrant Elbow 10X7IBHL \$ 9.20  
 1" Barb x 1" Barb x 3/4" Male Thread...Brass Hydrant Tee 10IBHT \$ 12.10



**COPPER SWEAT MALE ADAPTERS - - Copper Sweat x Male Pipe Thread**  
 3/4" 7CSMA \$ 1.70 1" 10CSMA \$ 4.10

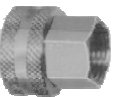

**BRASS HOSE ADAPTERS - - - Hose Thread x Pipe Thread**  
 H4 \$ 2.95 3/4" Male Hose Thread x 3/4" Male Pipe Thread  
 H5 \$ 2.95 3/4" Male Hose Thread x 1/2" Male Pipe Thread  
 H8 \$ 2.95 3/4" Male Hose Thread x 3/4" Male Hose Thread  
 H11 \$ 4.40 3/4" Male Hose Thread x 1" Female Pipe Thread  
 H7 \$ 3.25 3/4" Female Hose Thread x Combination 3/4" Male & 1/2" Female Pipe Thread  
 S1 \$ 3.70 3/4" Female Hose Thread x 1/2" Female Pipe Thread - - Swivel Style  
 S2 \$ 3.70 3/4" Female Hose Thread x 3/4" Female Pipe Thread - - Swivel Style  
 S3 \$ 3.70 3/4" Female Hose Thread x 3/4" Female Hose Thread - - Swivel Style

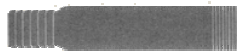

**SPECIAL GALVANIZED STEEL JET PUMP INSERT FITTINGS**  
 1" x 10" Galvanized Steel Venturi Adapters \$ 9.45 1X10IGVA  
 1-1/4" x 10" Galvanized Steel Venturi Adapters \$ 14.65 114X10IGVA  
 ( Barb x Male Thread - 10" Long to Cover Venturi Tube of Ejector package. )  
 1" Long Turn 90 Degree Well Seal Sweeps - Barb x Barb \$ 13.50 11GWS  
 1-1/4" Long Turn 90 Degree Well Seal Sweeps - Barb x Barb \$ 21.50 114IGWS



**RUBBER TRANSITION COUPLINGS with Stainless Steel Clamps**  
 4" x 4" 4X4RCOUP \$ 7.95 Used to couple 2 pieces of 4" pipe together - can be different materials  
 6" x 4" 6X4RCOUP \$ 17.75 Used to couple 6" pipe to 4" pipe - can be different materials  
 6" x 6" 6X6RCOUP \$ 16.25 Used to couple 2 pieces of 6" pipe together - can be different materials  
 8" x 6" 8X6RCOUP \$ 28.00 Used to couple 8" pipe to 6" pipe - can be different materials  
 8" x 8" 8X8RCOUP \$ 25.00 Used to couple 2 pieces of 8" pipe together - can be different materials